



FPGWORLD.COM

# ENCORE

## SERIES 8 BAIN MARIE FREESTANDING 900 HEATED

RANGE	ENCORE SERIES 8 BAIN MARIE	
TEMPERATURE	HEATED	
MODEL	IN-EC09-BM-08-A001	IN-EC09-BM-08-A002
FRONT	SQUARE/ TILT FRONT	SQUARE/ SLIDING DOORS
INSTALLATION	FREESTANDING	
HEIGHT	1450mm	
WIDTH	900mm	
DEPTH	662mm	

TEMPERATURE RANGE	+55°C - +90°C
RECOMMENDED CORE PRODUCT TEMPERATURE	+65°C - +80°C
ENVIRONMENTAL TEST CONDITIONS	22°C / 65% RH

### FEATURES

- High energy efficiency: 0.66 kWh per hour (average)
- Cabinet operating temperature range +55°C - +90°C  
Recommended core product temperature +65°C - +80°C

- Smart display with double-glazed glass finished with a black trim

#### Tilt Front or Sliding Doors Heated Display

- One tiltable, height-adjustable stainless steel wire rack shelf is full cabinet width to support maximum display capacity
- Unique shelf mounted front ticket strip 30mm together with rear ticket holder
- Shelf fitted with halogen heat lamps, with 3000 hour warm white lighting
- 25,000 hour LED lighting system at 2758 lumens per metre in cabinet top
- Supplied with 2x 1/1 gastronorm dish 65mm deep

#### Operational Excellence

- Sliding doors (staff side) and tilt front or sliding doors options (customer side)
- Constructed from stainless and mild steel with fully double-glazed, low-E coated, toughened safety glass for maximum energy efficiency, climate control and durability
- Low wattage density element in base provides even temperature distribution
- Dry operation well only
- Fitted with adjustable 150mm legs (+30mm adjustment)



Showing : Encore Series 8 Bain Marie heated 900mm square freestanding tilt front

### OPTIONS & ACCESSORIES

Contact a [FPG Sales Representative](#) for our full range, including:

- Shelf trays: Toughened safety glass or mild steel. Colour and woodprint options available for steel.
- Stainless steel product trays
- Stainless steel pie chutes
- GN pans (various sizes)
- GN dividers
- Branded decals
- Shelf ticket strips: powdercoat colour
- Forward-facing controls
- Sides: mirror effect
- Tray race
- Bumper rail with optional product bin
- Rear Sling Doors that slide and swing
- Rear deck assemblies
- Rear ambient drawer with dividers
- Toe kick
- Castors or rollers
- Custom joinery solution



Please contact FPG to discuss your requirements for meeting country-specific standards.

### HEATED DATA

MODEL	TEMPERATURE RANGE	RECOMMENDED CORE PRODUCT TEMPERATURE	ENVIRONMENTAL TEST CONDITIONS	HEATING
IN-EC09-BM-08-Axxx	+55°C – +90°C	+65°C – +80°C	22°C / 65% RH	Low wattage density element / 2x 100 watt linear halogen

### ELECTRICAL DATA

MODEL	VOLTAGE	PHASE	CURRENT	E24H (kWh)	kWh per hour (average)	IP RATING	MAINS		LED	HALOGEN LIGHTING	
							CONNECTION	CONNECTION PLUG <sup>1</sup>	HOURS	HOURS	COLOUR
IN-EC09-BM-08-Axxx	220-240 V	Single	8.8 A	15.85	0.66	IP 21	3 metre, 3 core cable	10 amp, 3 pin plug	25,000	3000	Warm white

<sup>1</sup>Please advise country to change plug specification.

### CAPACITY, ACCESS & CONSTRUCTION

MODEL	DISPLAY AREA	LEVELS	NO. OF 1/1 PANS	ACCESS FRONT	ACCESS REAR	CHASSIS CONSTRUCTION
IN-EC09-BM-08-A001	0.70 m <sup>2</sup>	1 Shelf + Base pans	2	Tilt front	Sliding doors	Stainless 304 and mild steel
IN-EC09-BM-08-A002				Sliding doors		

### DIMENSIONS

MODEL	H x W x D mm (Uncrated)	MASS (Uncrated)
IN-EC09-BM-08-A001	1450 x 900 x 662	145 kg
IN-EC09-BM-08-A002		144 kg

Crated weights and dimensions vary. Please contact us for information on your shipment.

#### Installation note:

Model cutout dimensions: IN-EC09-BM-08-A001 & A002 models require 908 x 668mm benchtop cutout. Joinery height 595mm (see product manual for installation guide). Optional front bumper rail recommended to complement cabinet/joinery finish.

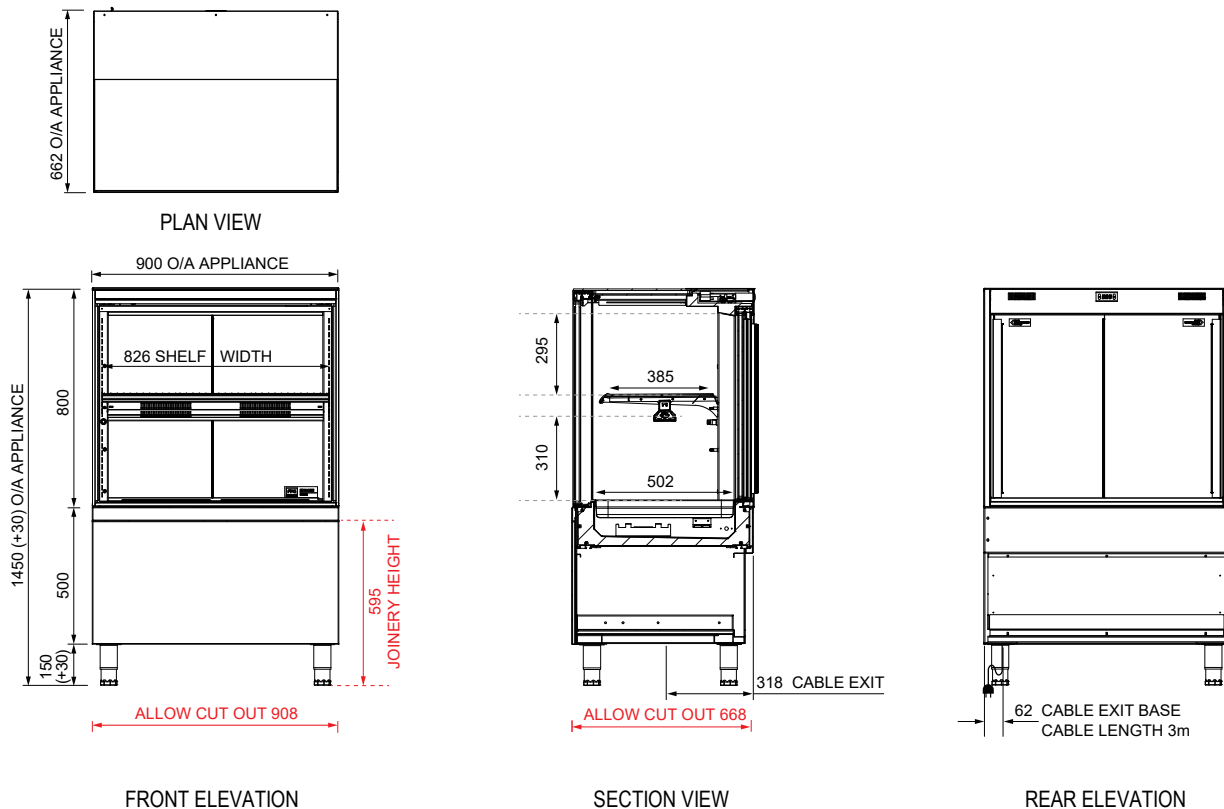

For information on technical data and installation guidelines please contact [support@fpgworld.com](mailto:support@fpgworld.com)

In line with our policy to continually develop, improve and support our products, Future Products Group Ltd reserves the right to change specifications and design without notice.

Have a question? Please email us at [sales@fpgworld.com](mailto:sales@fpgworld.com) or visit [www.fpgworld.com](http://www.fpgworld.com) for full contact details for your region.

