

|               |                         |
|---------------|-------------------------|
| RANGE         | ISOFORM GRAB&GO         |
| TEMP. TOP     | REFRIGERATED/TILT FRONT |
| TEMP. BOTTOM  | REFRIGERATED/OPEN FRONT |
| MODEL         | I-GG-RR-12-14-A003      |
| INSTALLATION  | FREESTANDING            |
| REFRIGERATION | INTEGRAL, R449a         |
| HEIGHT        | 1454mm                  |
| WIDTH         | 1208mm                  |
| DEPTH BASE    | 915mm                   |

|                               |                                  |
|-------------------------------|----------------------------------|
| CORE PRODUCT TEMPERATURE      | +2°C – +4°C                      |
| ENVIRONMENTAL TEST CONDITIONS | CLIMATE CLASS 3<br>25°C / 60% RH |
| CABINET CLASSIFICATION        | 3M1                              |

| ENERGY EFFICIENCY   |
|---|
| NZ & AU<br>For Star Rating, please visit <a href="http://reg.energyrating.gov.au/comparator">reg.energyrating.gov.au/comparator</a> |

## FEATURES

- High energy efficiency: 0.65 kWh per hour (average)**
- Maintains an average of +2°C - +4°C core product temperature at Climate Class 3 25°C / 60% RH**
  - Sleek black cabinet frame with silver pinstripe (default) on front, rear and doors and grille to front panel
- 50,000 hour LED lighting system (colour: natural) at 1500 lumens per metre in both top and bottom displays

### Tilt Front Refrigerated Top Display

- High internal humidity maintains and extends shelf life
  - Tilt front glass provides easy access for cleaning
  - Base ticket strip: 30mm (height)

### Open Front Refrigerated Bottom Display

- Fixed-height shelf and base, powdercoated black (default) are full cabinet width to support maximum display capacity
- Shelf can be flat or tilted 7°
- Unique front ticket strip holder 30mm on shelf and base, and to the rear of shelf

### Operational Excellence

- 'Plug and play' - integral refrigeration
- Dual Action Doors (staff side) - doors both slide and swing for full-width access to the cabinet
- Constructed from stainless and mild steel with fully double-glazed, toughened safety glass for maximum energy efficiency, climate control and durability
- Configured with a pre-filter - with regular cleaning by operations staff the life of the cabinet can be extended
  - Auto Condensate Removal (ACR)
  - Fitted with unidirectional rollers and adjustable stabilisers



Showing: Isoform Grab&Go 1208mm width x 1454mm height  
Top Display: Refrigerated, tilt front. Bottom Display: Refrigerated, open front with shelf

## OPTIONS & ACCESSORIES

Contact a [FPG Sales Representative](#) for our full range, including:

- Remote refrigeration with TX, EPR or Solenoid valves for connection
- Flat front panel to base on cabinets with remote refrigeration
- Pinstripe colour
- Shelf trays: Toughened safety glass or brushed stainless steel. Colour and woodprint options available for steel shelf trays
- Branded decals
- Sides: mirror effect
- LED lighting colour: Warm white
- Lockable castors
- Isoform Sealing Kit
- Top Display**
  - Additional shelf
- Bottom Display**
  - Gravity feed system
  - Night curtain

#### REFRIGERATION DATA

| MODEL              | CORE PRODUCT TEMPERATURE | ENVIRONMENTAL TEST CONDITIONS   | REFRIGERATION | REFRIGERANT | CONDENSATE REMOVAL |
|--------------------|--------------------------|---------------------------------|---------------|-------------|--------------------|
| I-GG-RR-12-14-A003 | +2°C - +4°C              | Climate Class 3 - 25°C / 60% RH | Integral      | R449a       | ACR                |

#### ELECTRICAL DATA

| MODEL              | VOLTAGE   | PHASE  | CURRENT | E24H (kWh) | kWh per hour (average) | IP RATING | MAINS                |                              | LED LIGHTING |                |         |
|--------------------|-----------|--------|---------|------------|------------------------|-----------|----------------------|------------------------------|--------------|----------------|---------|
|                    |           |        |         |            |                        |           | CONNECTION           | CONNECTION PLUG <sup>1</sup> | HOURS        | LUMENS         | COLOUR  |
| I-GG-RR-12-14-A003 | 220-240 V | Single | 7.6 A   | 15.64      | 0.65                   | IP 22     | 3 metre 3 core cable | 10 amp 3 pin plug            | 50,000       | 1500 per metre | Natural |

<sup>1</sup>Please advise country to change plug specification.

#### CAPACITY, ACCESS & CONSTRUCTION

|                | SHELF DISPLAY AREA  | LEVELS         | ACCESS FRONT | ACCESS REAR       | REAR DOORS | CHASSIS CONSTRUCTION         |
|----------------|---------------------|----------------|--------------|-------------------|------------|------------------------------|
| TOP DISPLAY    | 0.50 m <sup>2</sup> | Base only      | Tilt front   | Dual Action doors | 2          | Stainless 304 and mild steel |
| BOTTOM DISPLAY | 0.95 m <sup>2</sup> | 1 Shelf + Base | Open front   | Dual Action doors | 2          |                              |

#### DIMENSIONS

| MODEL              | H x W x D mm (Uncrated) | MASS (Uncrated) |
|--------------------|-------------------------|-----------------|
| I-GG-RR-12-14-A003 | 1454 x 1208 x 915       | - kg            |

Crated weights and dimensions vary. Please contact us for information on your shipment.

##### Installation note:

Designed to be installed as a stand alone unit. Model cutout dimensions: I-GG-RR-12-14 models require 1218 x 920mm benchtop cutout. Joinery height 407mm (see product manual for installation guide). When installing this cabinet next to an adjacent Isoform refrigerated or controlled ambient cabinet, please install an Isoform Sealing Kit (accessory) between them.

**UNOBSTRUCTED AIRFLOW MUST BE MAINTAINED TO ENSURE UNIT PERFORMANCE AND TO MAINTAIN WARRANTY.**

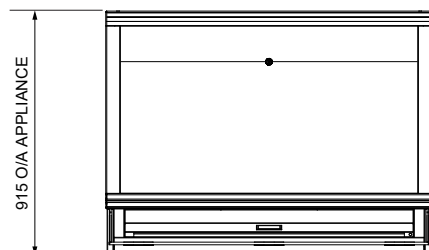

PLAN VIEW

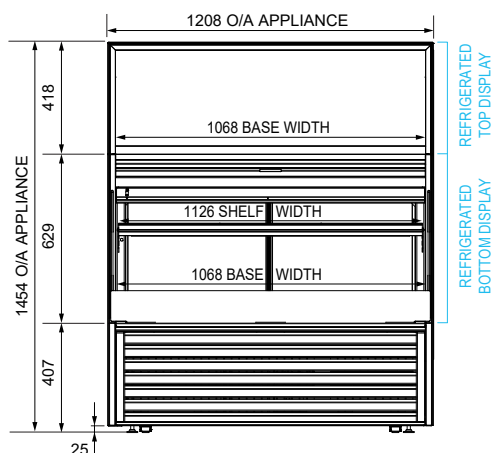

FRONT ELEVATION

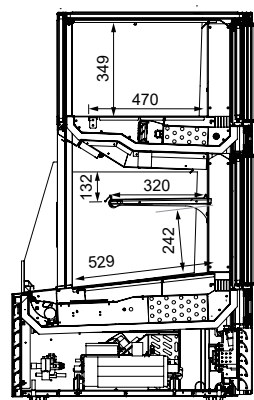

SECTION VIEW

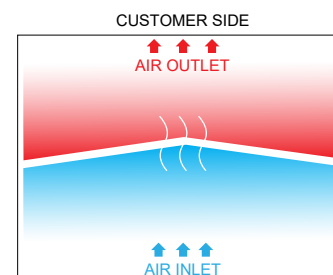

PLAN VIEW  
FREEFLOW AIR TECHNOLOGY

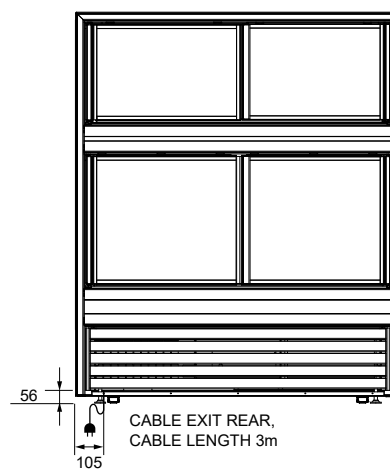

REAR ELEVATION

For information on technical data and installation guidelines please contact [support@fpgworld.com](mailto:support@fpgworld.com)

In line with our policy to continually develop, improve and support our products, Future Products Group Ltd reserves the right to change specifications and design without notice.

Have a question? Please email us at [sales@fpgworld.com](mailto:sales@fpgworld.com) or visit [www.fpgworld.com](http://www.fpgworld.com) for full contact details for your region.



Worldwide  
contact  
details: