

INLINE SERIES - 3000 CONTROLLED AMBIENT 600mm SQUARE ON COUNTER

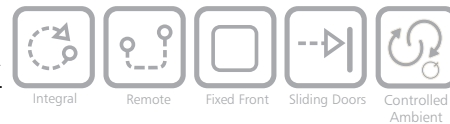

MODELS

- IN-3CA06-SQ-FF-OC-I | 3000 Series controlled ambient 600mm square, with fixed front glass, on counter, with integral condensing unit
- IN-3CA06-SQ-SD-OC-I | 3000 Series controlled ambient 600mm square, with sliding glass doors, on counter, with integral condensing unit
- IN-3CA06-SQ-FF-OC-R | 3000 Series controlled ambient 600mm square, with fixed front glass, on counter, for remote condensing unit
- IN-3CA06-SQ-SD-OC-R | 3000 Series controlled ambient 600mm square, with sliding glass doors, on counter, for remote condensing unit

OPTIONS [F=Factory Fitted]

- Auto condensate removal (F)
- EPR valve or Solenoid valve for remote connection (F)
- LED lighting to shelves (F)

ACCESSORIES [A=Accessory]

- Toughened glass shelves (A)
- Angled base shelf (A)
- Rear decks (A)
- Thermal divider panels (A)

OVERVIEW

Created as a medium duty solution for café, kiosk and c-store, these cabinets provide a plug and go solution that allows 60 door openings per hour while maintaining core product temperatures. Packaged with the same key benefits of the FPG product range, you use less energy while still maintaining food safety. The Inline 3000 construction allows for smart counter integration options of either a recessed, countertop mounting or freestanding display.

FEATURES

- High energy efficiency - 0.18 kWh per hour average
- Maintains +15°C - +18°C core product temperature with up to 60 door openings per hour
- Sliding doors (staff side) and fixed front or sliding doors options (customer side)
- Two adjustable shelves and base for product display
- 50,000 hour LED lighting to cabinet top and optional shelf lighting available
- High internal humidity maintains and extends product shelf life
- Fully double glazed for energy efficiency
- Fascia and base extrusions can be fitted with clip-in decorative inserts
- Unique shelf mounted ticket strip front and rear
- Remote display cabinet supplied with standard R134A TX valve
- Freeflow air technology (no front counter vents required)
- Also available as a in counter model or a freestanding model with a chassis



SHOWING : 3000 SERIES CONTROLLED AMBIENT 600mm SQUARE, WITH FIXED FRONT, ON COUNTER, WITH INTEGRAL CONDENSING UNIT

KEY SELLING FEATURES

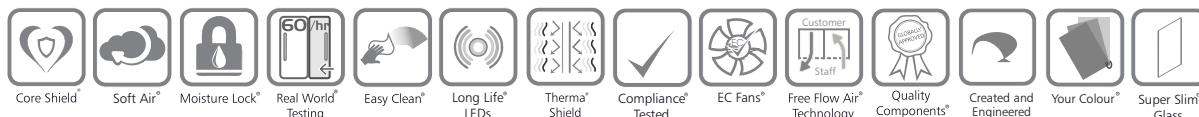

| | | | | |
|---------------------|-------------------------------|----------------------------------|-------------------|-------------|
| IN-3CA06-SQ-FF-OC-I | ENVIRONMENTAL TEST CONDITIONS | CLIMATE CLASS 3 25°C / 60% RH | TEMPERATURE RANGE | +15°C-+18°C |
| IN-3CA06-SQ-SD-OC-I | | | | |
| IN-3CA06-SQ-FF-OC-R | | | | |
| IN-3CA06-SQ-SD-OC-R | | | | |

Designed to meet and exceed the following compliances and approvals : NSF, EN 55014, EN55014-1, EN 55014-2, EN 61000, EN 61000-3-2, EN 61000-3-3, IEC 60335, IEC 60335-1, IEC 60335-2-89.



VIEW ONLINE AT FPGWORLD.COM



INLINE SERIES - 3000 CONTROLLED AMBIENT 600mm SQUARE ON COUNTER

SPECIFICATIONS

Refrigeration Data

| | ENVIRONMENTAL TEST CONDITIONS | CORE PRODUCT TEMP RANGE | REFRIGERANT | REFRIGERANT CHARGE | REMOTE CONNECTION | CONDENSATE REMOVAL |
|---------------------|---------------------------------|-------------------------|------------------------------------|--------------------|---------------------------------------|--------------------|
| IN-3CA06-SQ-FF-OC-I | Climate Class 3 - 25°C / 60% RH | +15°C - +18°C | R134A | See serial label | N/A | Manual/Auto* |
| IN-3CA06-SQ-SD-OC-I | Climate Class 3 - 25°C / 60% RH | +15°C - +18°C | R134A | See serial label | N/A | Manual/Auto* |
| IN-3CA06-SQ-FF-OC-R | Climate Class 3 - 25°C / 60% RH | +15°C - +18°C | R134A (unless otherwise specified) | N/A | TX valve, EPR valve*, Solenoid valve* | N/A |
| IN-3CA06-SQ-SD-OC-R | Climate Class 3 - 25°C / 60% RH | +15°C - +18°C | R134A (unless otherwise specified) | N/A | TX valve, EPR valve*, Solenoid valve* | N/A |

*Option or Accessory

Please note: Refrigeration duty: 260W @ -5°C SST & 35°C condensing

Please note: Remote condensing unit not supplied

Electrical Data

| | VOLTAGE | PHASE | CURRENT | kWh per hour [average] | MAINS CONNECTION | MAINS CONNECTION PLUG | IP RATING | ACR POWER * | ACR CURRENT* | LED LIGHTING |
|---------------------|-----------|--------|---------|------------------------|----------------------|-----------------------|-----------|-------------|--------------|---------------|
| IN-3CA06-SQ-FF-OC-I | 220-240 V | Single | 1.4 A | 0.18 kWh per hour | 3 metre 3 core cable | 10 amp, 3 pin plug | IP 22 | 400 W | 1.7 A | 50,000 hr LED |
| IN-3CA06-SQ-SD-OC-I | 220-240 V | Single | 1.4 A | 0.18 kWh per hour | 3 metre 3 core cable | 10 amp, 3 pin plug | IP 22 | 400 W | 1.7 A | 50,000 hr LED |
| IN-3CA06-SQ-FF-OC-R | 220-240 V | Single | 0.5 A | - | 3 metre 3 core cable | 10 amp, 3 pin plug | IP 22 | N/A | N/A | 50,000 hr LED |
| IN-3CA06-SQ-SD-OC-R | 220-240 V | Single | 0.5 A | - | 3 metre 3 core cable | 10 amp, 3 pin plug | IP 22 | N/A | N/A | 50,000 hr LED |

*Option or Accessory

Auto Condensate Removal = ACR

Display

| | DISPLAY AREA | NO. OF SHELVES | ACCESS - FRONT | ACCESS - REAR | DOOR OPENINGS @ +2°C - +4°C | CONSTRUCTION |
|---------------------|--------------------|----------------|----------------|---------------|-----------------------------|---------------------|
| IN-3CA06-SQ-FF-OC-I | 0.51m ² | 2 + Base | Fixed front | Sliding doors | 60 openings per hour | 304 Stainless Steel |
| IN-3CA06-SQ-SD-OC-I | 0.51m ² | 2 + Base | Sliding doors | Sliding doors | 60 openings per hour | 304 Stainless Steel |
| IN-3CA06-SQ-FF-OC-R | 0.51m ² | 2 + Base | Fixed front | Sliding doors | 60 openings per hour | 304 Stainless Steel |
| IN-3CA06-SQ-SD-OC-R | 0.51m ² | 2 + Base | Sliding doors | Sliding doors | 60 openings per hour | 304 Stainless Steel |

Dimensions [Uncrated and Crated]

| | H x W x D mm [Uncrated] | MASS [Uncrated] | H x W x D mm [Crated] | MASS [Crated] | CUBIC VOLUME [Crated] |
|---------------------|-------------------------|-----------------|-----------------------|---------------|-----------------------|
| IN-3CA06-SQ-FF-OC-I | 1129 x 600 x 662 | - | 1289 x 677 x 737 | 150 kg | 0.67m ³ |
| IN-3CA06-SQ-SD-OC-I | 1129 x 600 x 662 | - | 1289 x 677 x 737 | 150 kg | 0.67m ³ |
| IN-3CA06-SQ-FF-OC-R | 774 x 600 x 662 | - | 940 x 677 x 737 | - | 0.46m ³ |
| IN-3CA06-SQ-SD-OC-R | 774 x 600 x 662 | - | 940 x 677 x 737 | - | 0.46m ³ |

Installation note:

Model cutout dimensions:

IN-3CA06-SQ-FF-OC-I and IN-3CA06-SQ-SD-OC-I models require 564 x 477mm benchtop cutout (see product manual for installation guide)

Unobstructed airflow must be maintained to ensure unit performance and maintain warranty

In line with policy to continually develop and improve its products, Future Products Group reserves the right to change specifications and design without notice.

For more information and technical data, including installation documents, please refer to the website - www.fpgworld.com

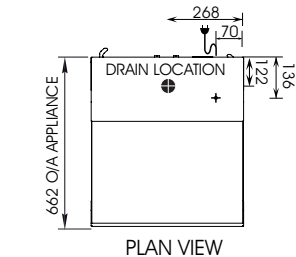

PLAN VIEW

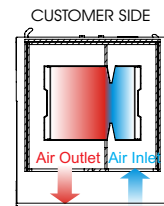

PLAN VIEW FREEFLOW AIR TECHNOLOGY

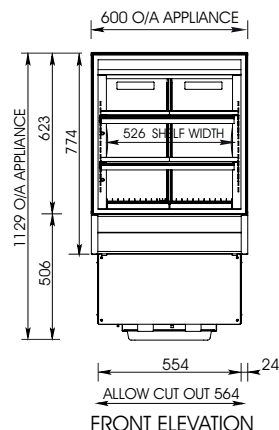

FRONT ELEVATION

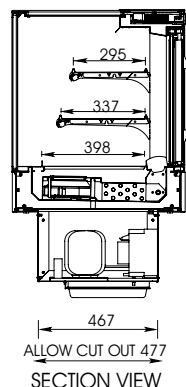

SECTION VIEW

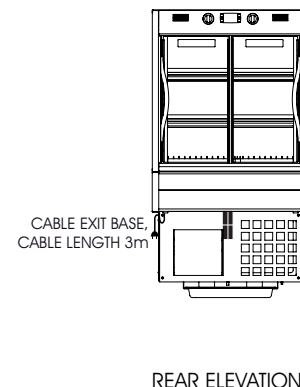

REAR ELEVATION